

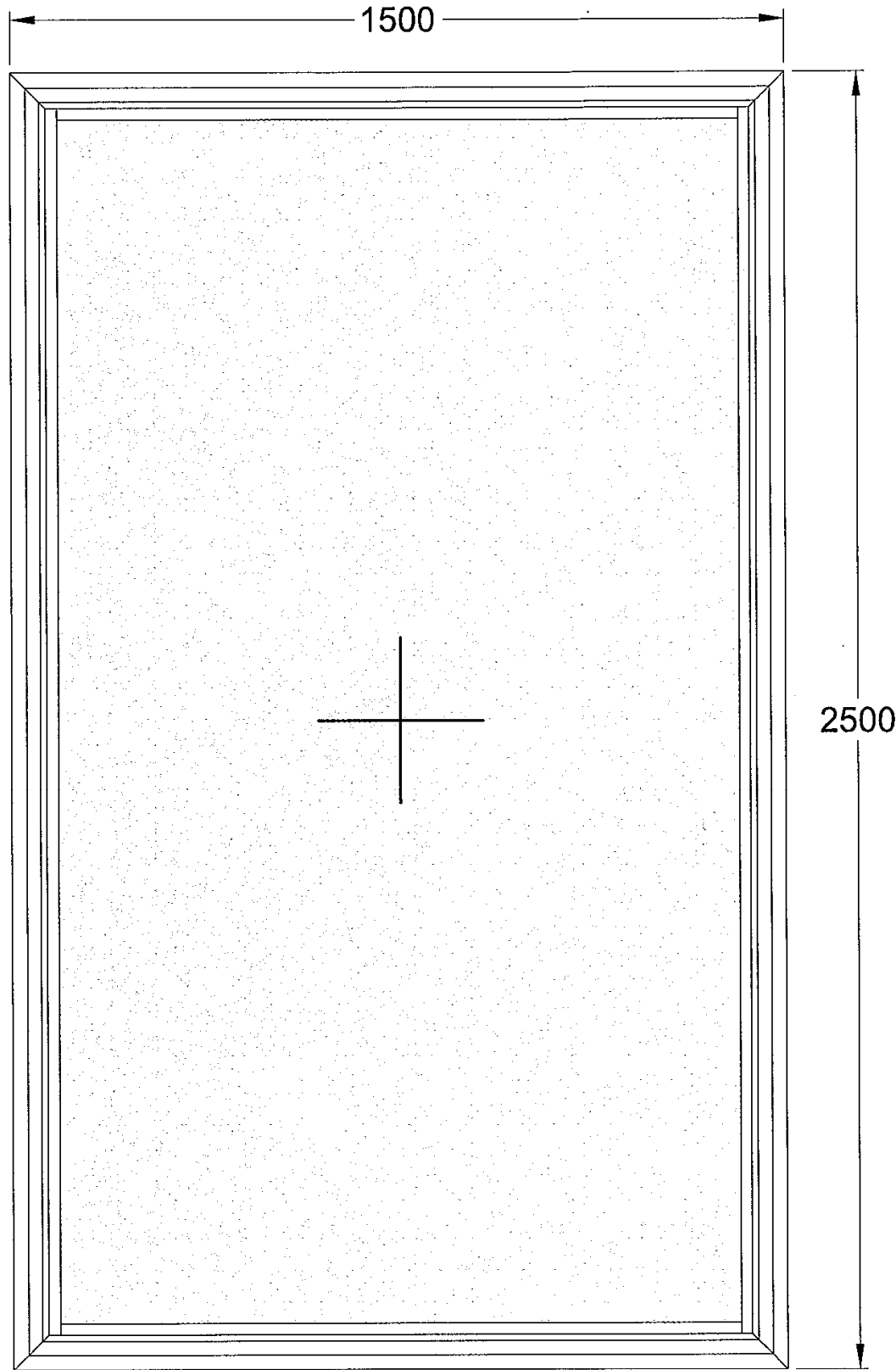

PRODUCT #2
Testing as per NAFS 2011 Class AW-PG50-Type FW

ELEVATION
(INTERNAL SIDE)



	CONFORME DOSSIER AI-04900-B COMPLIES TO FILE
	CLEB laboratoire inc. / CLEB laboratory Inc. 2018-10-03 VÉRIFIÉ / CHECKED

2018-10-03

PRODUCT #2
Testing as per NAFS 2011 Class AW-PG50-Type FW

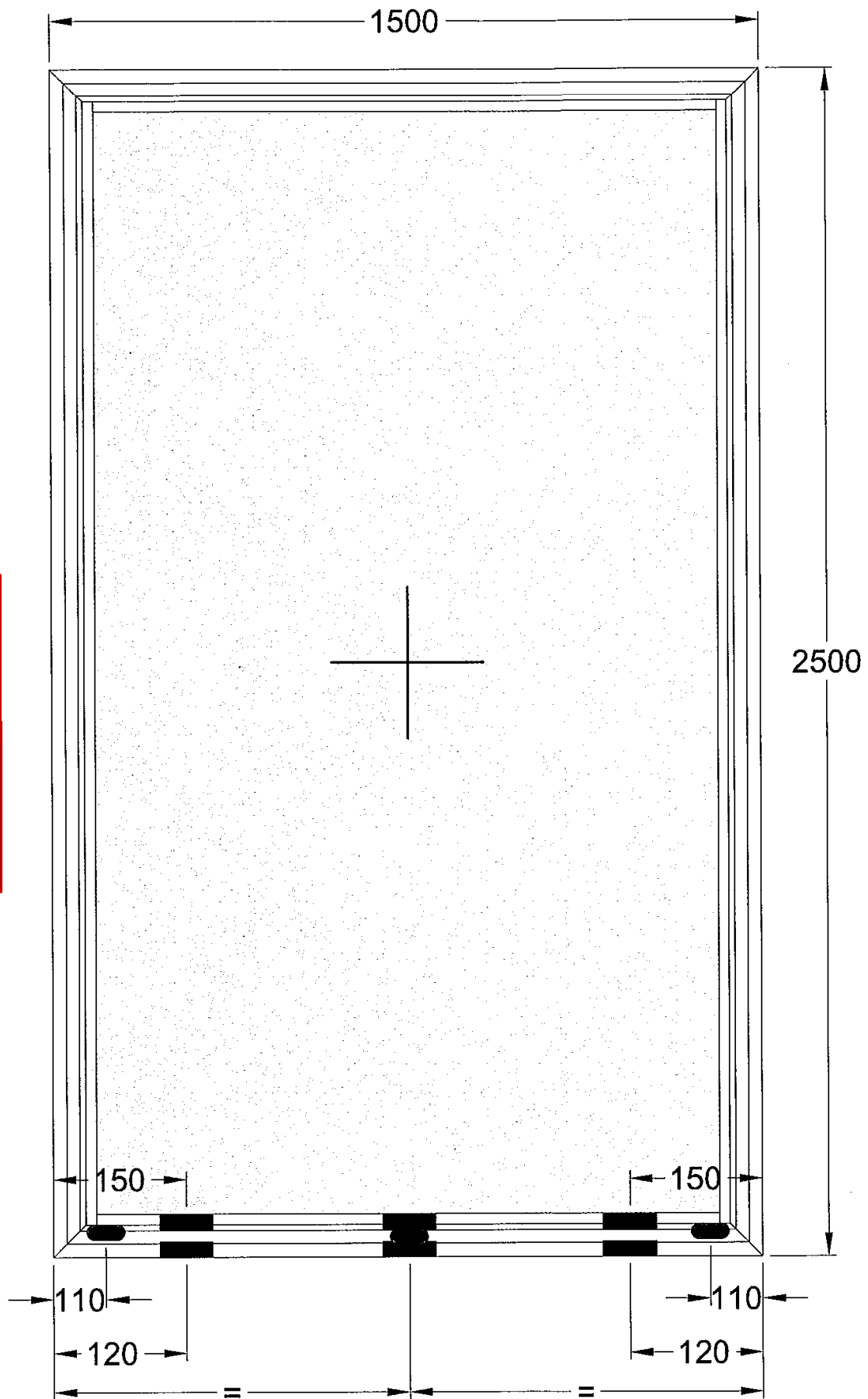

	CONFORME DOSSIER AI-04900-B COMPLIES TO FILE
	CLEB laboratoire inc. / CLEB laboratory Inc. 2018-10-03 VÉRIFIÉ / CHECKED

	3 x 40mm FRAME DRAINAGE
	6 x 30mm EXTERNAL FRAME DRAINAGE

FRAME DRAINAGE
 EXTERNAL FRAME DRAINAGE

*DIMMENSIONS IN (mm)

ΠΙΣΩ ΟΨΗ
BACK VIEW

PRODUCT #2

Testing as per NAFS 2011 Class AW-PG50-Type FW

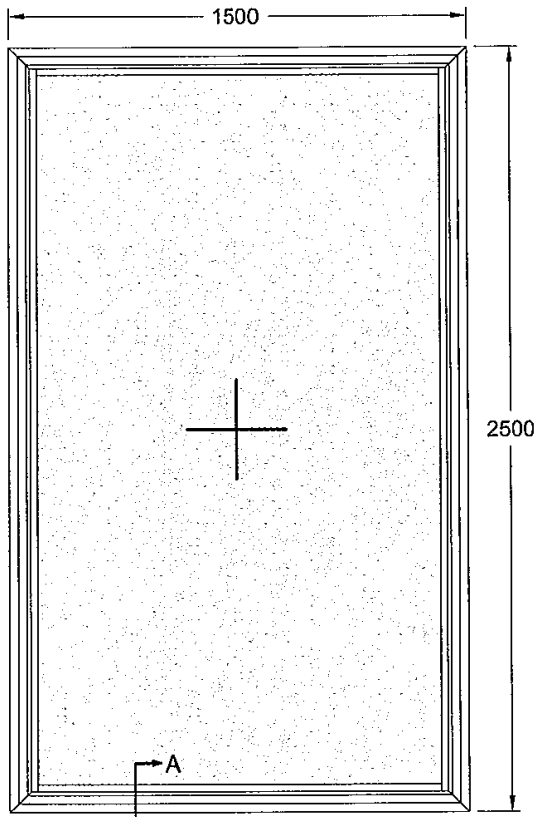

UL CLEB	CONFORME DOSSIER
	AI-04900-B
COMPLIES TO FILE	
UL CLEB	CLEB laboratoire inc.
	/
	CLEB laboratory Inc.
	2018-10-03
VÉRIFIÉ / CHECKED	

ΚΑΤΟΨΗ
TOP VIEW

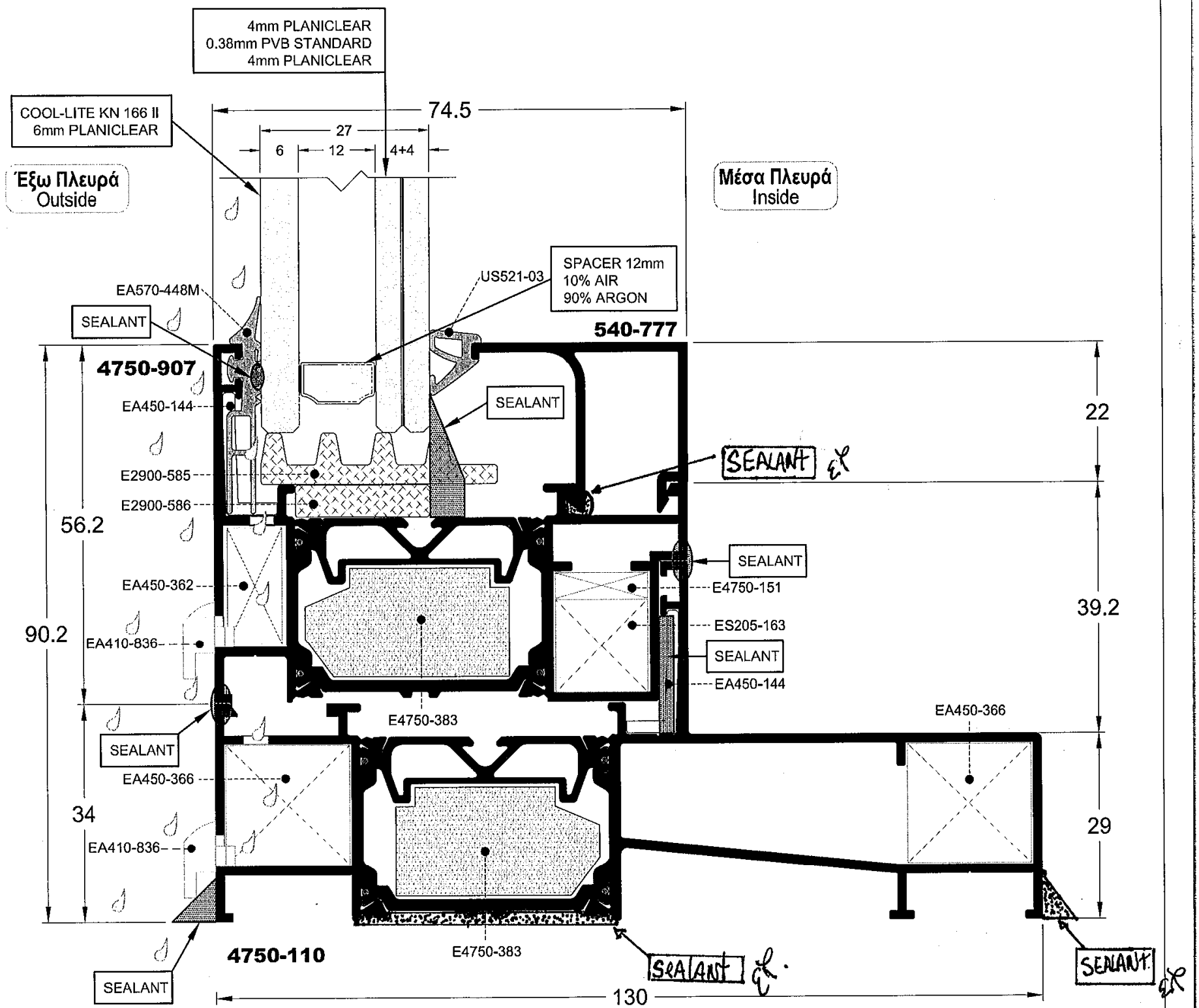
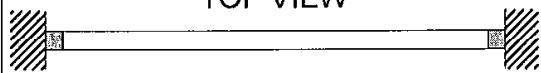

ΠΙΣΩ ΟΨΗ
BACK VIEW

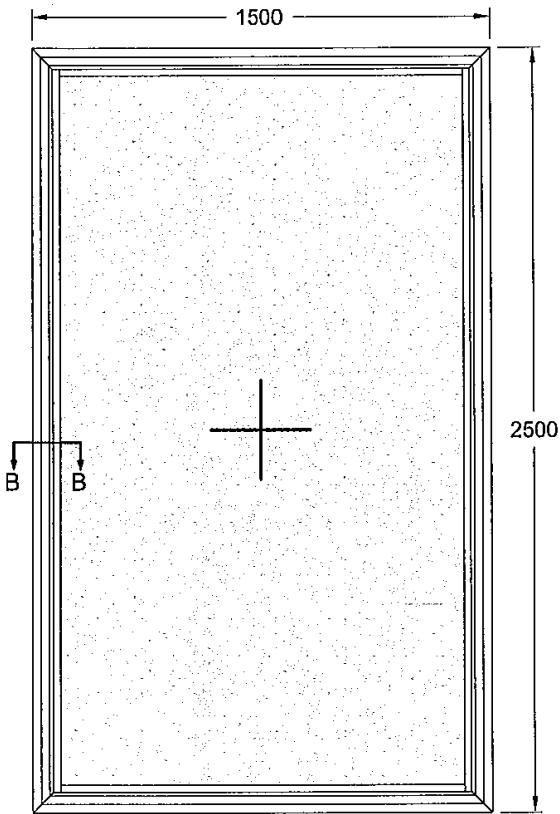

PRODUCT #2

Testing as per NAFS 2011 Class AW-PG50-Type FW

UL CLEB	CONFORME DOSSIER
	AI-04900-B COMPLIES TO FILE
UL CLEB	CLEB laboratoire inc.
	/
	CLEB laboratory Inc.
	2018-10-03
	VÉRIFIÉ / CHECKED

ΚΑΤΟΨΗ
TOP VIEW

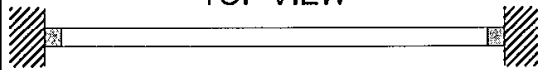

Έξω Πλευρά
Outside

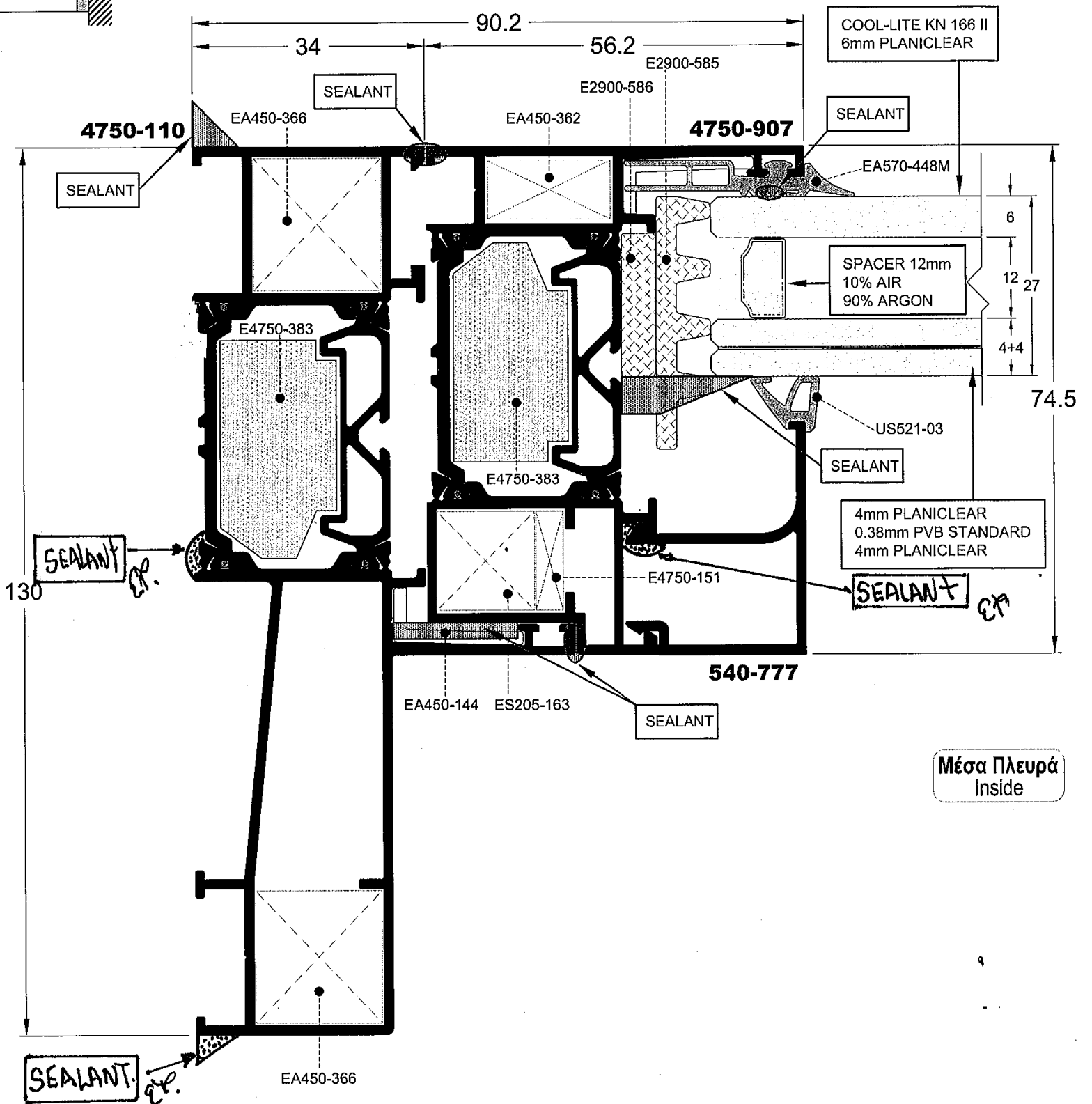

Μέσα Πλευρά
Inside

ΠΙΣΩ ΟΨΗ
BACK VIEW

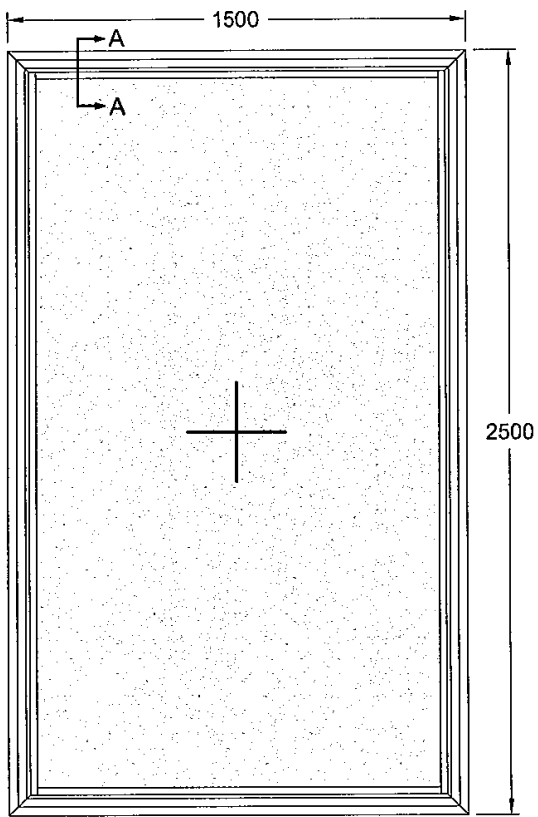

PRODUCT #2
Testing as per NAFS 2011 Class AW-PG50-Type FW

UL CLEB	CONFORME DOSSIER
	AI-04900-B COMPLIES TO FILE
UL CLEB	CLEB laboratoire inc.
	/
	CLEB laboratory Inc.
	2018-10-03
	VÉRIFIÉ / CHECKED

ΚΑΤΟΨΗ
TOP VIEW

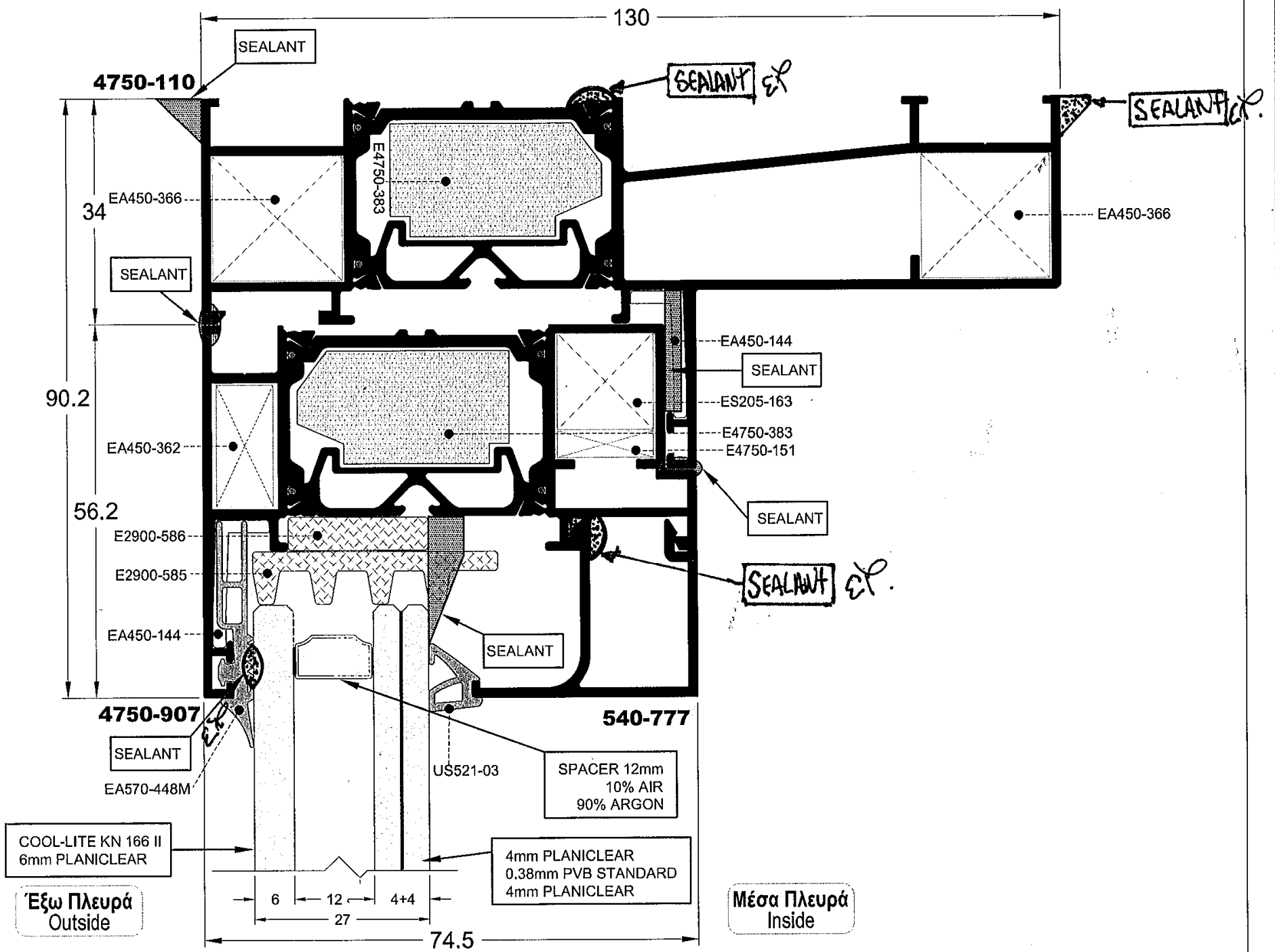
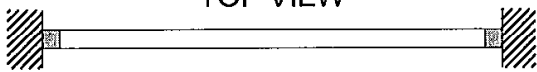

ΠΙΣΩ ΟΨΗ
BACK VIEW

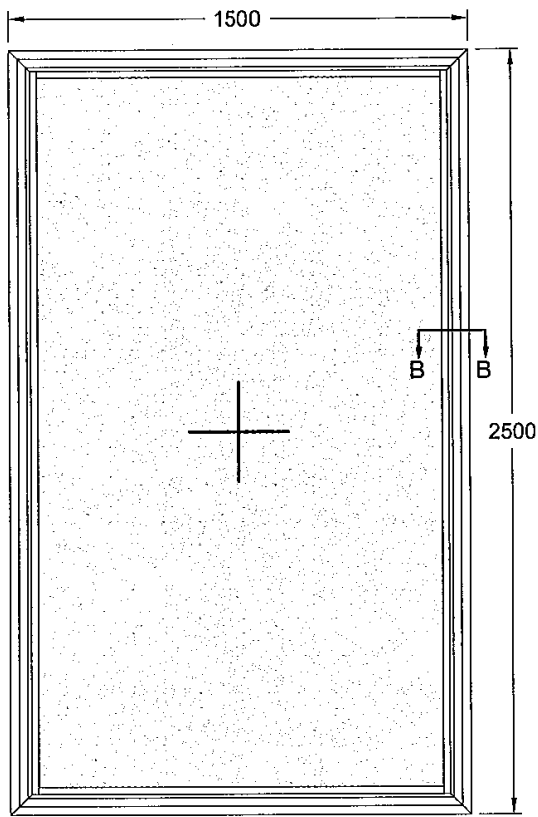

PRODUCT #2

Testing as per NA

50-Type FW

	CONFORME DOSSIER AI-04900-B COMPLIES TO FILE
	CLEB laboratoire inc. / CLEB laboratory Inc. 2018-10-03 VÉRIFIÉ / CHECKED

ΚΑΤΟΨΗ
TOP VIEW

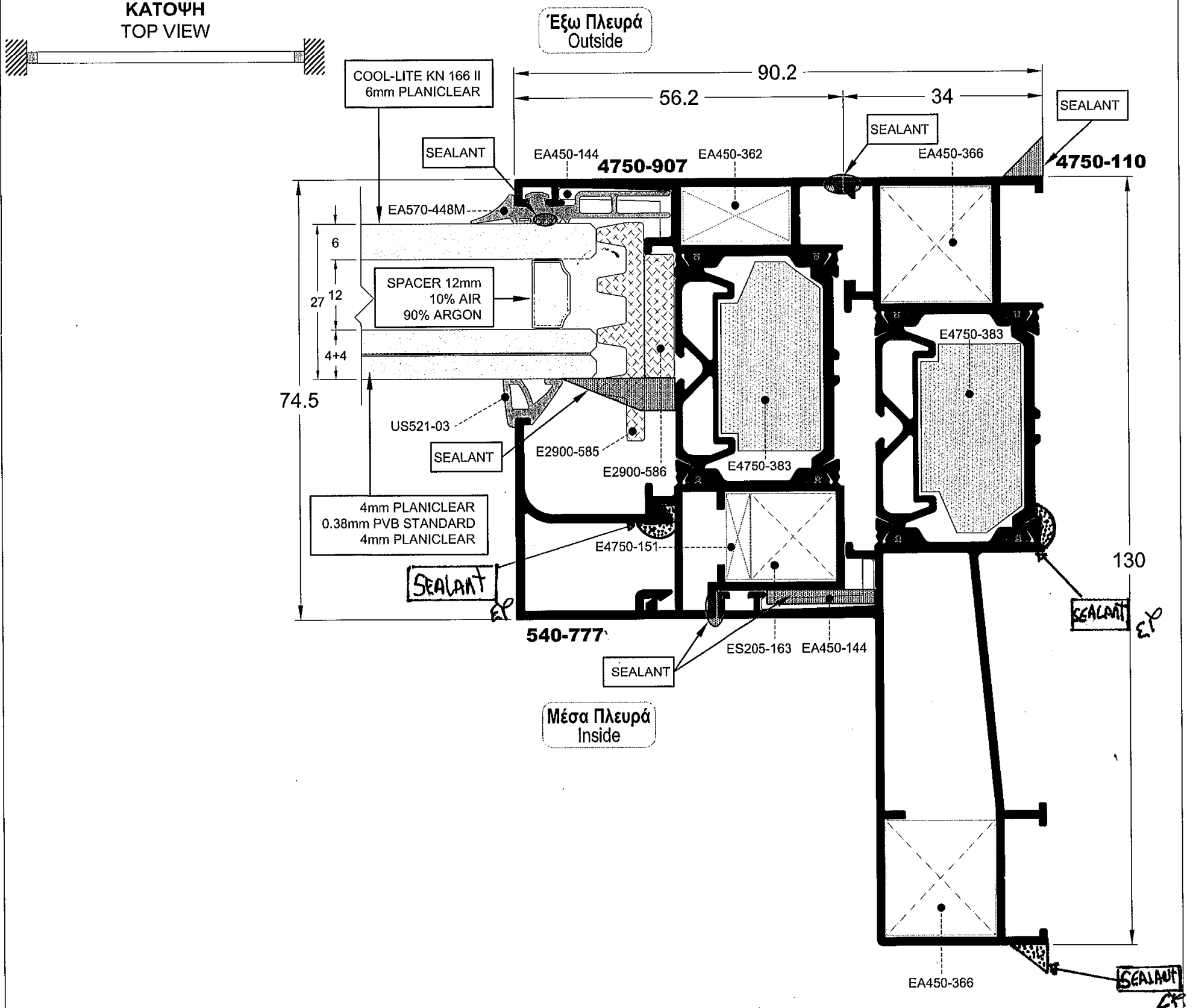

Build of Materials
For 1 fixed casement

PRODUCT #2
Testing as per NAFS 2011 Class AW-PG50-Type FW

A/A	Code	Description	Material
ΠΡΟΦΙΛ			
1	4750-110	ΚΑΣΑ-FRAME	8m
2	4750-907	ΚΑΣΑ ΑΛΛΑΓΗΣ ΦΟΡΑΣ-DIRECTION CHANGE FRAME	8m
3	540-777	ΠΙΧΑΚΙ-BEAD	7.4m
ΕΞΑΡΤΗΜΑΤΑ			
4	EA450-144P	ΠΛΑΣΤΙΚΗ ΓΩΝΙΑ ΕΥΘΥΓΡΑΜΜΙΣΗΣ-ALIGNMENT CORNER	8 pcs
5	ES205-163	ΓΩΝΙΑ ΣΥΝΔΕΣΕΩΣ CAL-CORNER JOINT CAL 14.5 x 14.5 mm	4 pcs
6	E4750-151	ΠΡΟΣΘΗΚΗ ΓΩΝΙΑΣ ΣΥΝΔΕΣΕΩΣ-ADDITIONAL CONN. CORNER 14.5 x4mm	4 pcs
7	EA450-362	ΓΩΝΙΑ ΓΩΝΙΑΣΤΡΑΣ-CRIMPING CORNER 8.9 x 18.6 mm	4 pcs
8	EA450-366	ΓΩΝΙΑ ΓΩΝΙΑΣΤΡΑΣ-CRIMPING CORNER 19.4 x 18.6mm	8 pcs
9	E4750-383	ΘΕΡΜΟΜΟΝΩΤΙΚΗ ΜΠΑΡΑ ΚΑΣΑΣ-FRAME INSULATION BAR	8x2m bars
10	E2900-585	ΑΦΡΟΣ ΜΟΝΩΣΗΣ-FOAM INSULATION 35x10mm	3x3m bars
11	E2900-586	ΑΦΡΟΣ ΜΟΝΩΣΗΣ-FOAM INSULATION 19x5mm	3x3m bars
12	EA570-448	ΕΞΩΤΕΡΙΚΟ ΛΑΣΤΙΧΟ ΤΖΑΜΙΟΥ-EXTERNAL GLAZING GASKET	8m
13	US521-03	ΛΑΣΤΙΧΟ ΣΦΗΝΑ ΤΖΑΜΙΟΥ-GLAZING GASKET	7.5m
14	EA410-836	ΤΑΠΑ ΝΕΡΟΧΥΤΗ-END COVER FOR WATER DRAINAGE	6 pcs

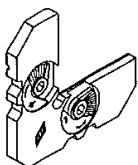
	<p>Κωδικός Code:</p> <p>EA450-140U</p>	<p>Περιγραφή: ΧΥΤΗ ΓΩΝΙΑ ΕΥΘΥΓΡΑΜΜΙΣΗΣ 24.5 mm</p> <p>Description: CAST ALIGNMENT CORNER 24.5 mm</p>
---	---	--

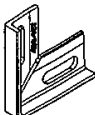
	<p>Κωδικός Code:</p> <p>EA450-144P</p>	<p>Περιγραφή: ΓΩΝΙΑ ΕΥΘΥΓΡΑΜΜΙΣΗΣ ΓΙΑ ΠΡΟΦΙΛ 450-105/107/108/110/112/113/907</p> <p>Description: ALIGNMENT CORNER FOR PROFILE 450-105/107/108/110/112/113/907</p> <p>P=ΠΛΑΣΤΙΚΗ-PLASTIC</p>
---	---	---

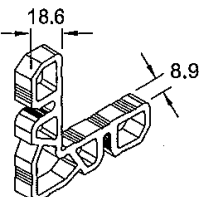
	<p>Κωδικός Code:</p> <p>EA450-362U</p>	<p>Περιγραφή: ΓΩΝΙΑ ΓΩΝΙΑΣΤΡΑΣ 8.9 x 18.6 mm</p> <p>Description: CRIMPING CORNER 8.9 x 18.6 mm</p>
--	---	--

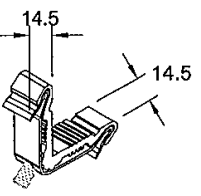
	<p>Κωδικός Code:</p> <p>ES205-163</p>	<p>Περιγραφή: ΓΩΝΙΑ ΣΥΝΔΕΣΕΩΣ CAL 14.5 x 14.5 mm</p> <p>Description: CORNER JOINT CAL 14.5 x 14.5 mm</p>
---	--	--

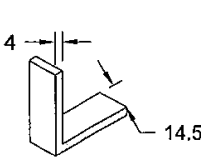

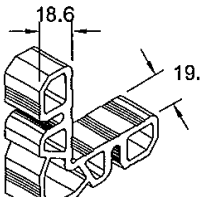
	<p>Κωδικός Code:</p> <p>E4750-151</p>	<p>Περιγραφή: ΠΡΟΣΘΗΚΗ ΓΩΝΙΑΣ ΣΥΝΔΕΣΕΩΣ 14.5 x 4 mm</p> <p>Description: ADDITIONAL CONNECTION CORNER 14.5 x 4 mm</p>
---	--	--

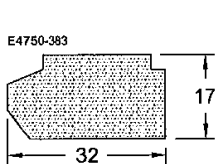
	<p>Κωδικός Code:</p> <p>EA450-366U</p>	<p>Περιγραφή: ΓΩΝΙΑ ΓΩΝΙΑΣΤΡΑΣ 19.4 x 18.6 mm</p> <p>Description: CRIMPING CORNER 19.4 x 18.6 mm</p>
---	---	--

	<p>Κωδικός Code:</p> <p>E4750-383</p>	<p>Περιγραφή: ΘΕΡΜΟΜΟΝΩΤΙΚΗ ΜΠΑΡΑ ΦΥΛΛΟΥ</p> <p>Description: CASEMENT INSULATION BAR</p>
---	--	--

	<p>Κωδικός Code:</p> <p>E2900-585</p>	<p>Περιγραφή: ΑΦΡΟΣ ΜΟΝΩΣΗΣ 35x10mm</p> <p>Description: FOAM INSULATION 35x10mm</p>
---	--	---

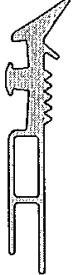
αδ συντάκτης

	<p>Κωδικός Code:</p> <p>E2900-586</p>	<p>Περιγραφή: ΑΦΡΟΣ ΜΟΝΩΣΗΣ 19x5mm Description: FOAM INSULATION 19x5mm</p>
	<p>Κωδικός Code:</p> <p>EA570-448M</p>	<p>Περιγραφή: ΕΞΩΤΕΡΙΚΟ ΚΟΥΜΠΩΤΟ ΛΑΣΤΙΧΟ ΤΖΑΜΙΟΥ 3mm (EPDM) Description: EXTERNAL GLAZING GASKET 3mm (EPDM)</p>
	<p>Κωδικός Code:</p> <p>US521-03 (6-7 mm)</p>	<p>Περιγραφή: ΛΑΣΤΙΧΟ ΣΦΗΝΑ ΤΖΑΜΙΟΥ Description: GLAZING GASKET</p>
	<p>Κωδικός Code:</p> <p>EA410-836M</p>	<p>Περιγραφή: ΤΑΠΑ ΝΕΡΟΧΥΤΗ Description: END COVER FOR WATER DRAINAGE</p>



20 2018/10/03

PRODUCT #2
Testing as per NAFS 2011 Class AW-PG50-Type FW

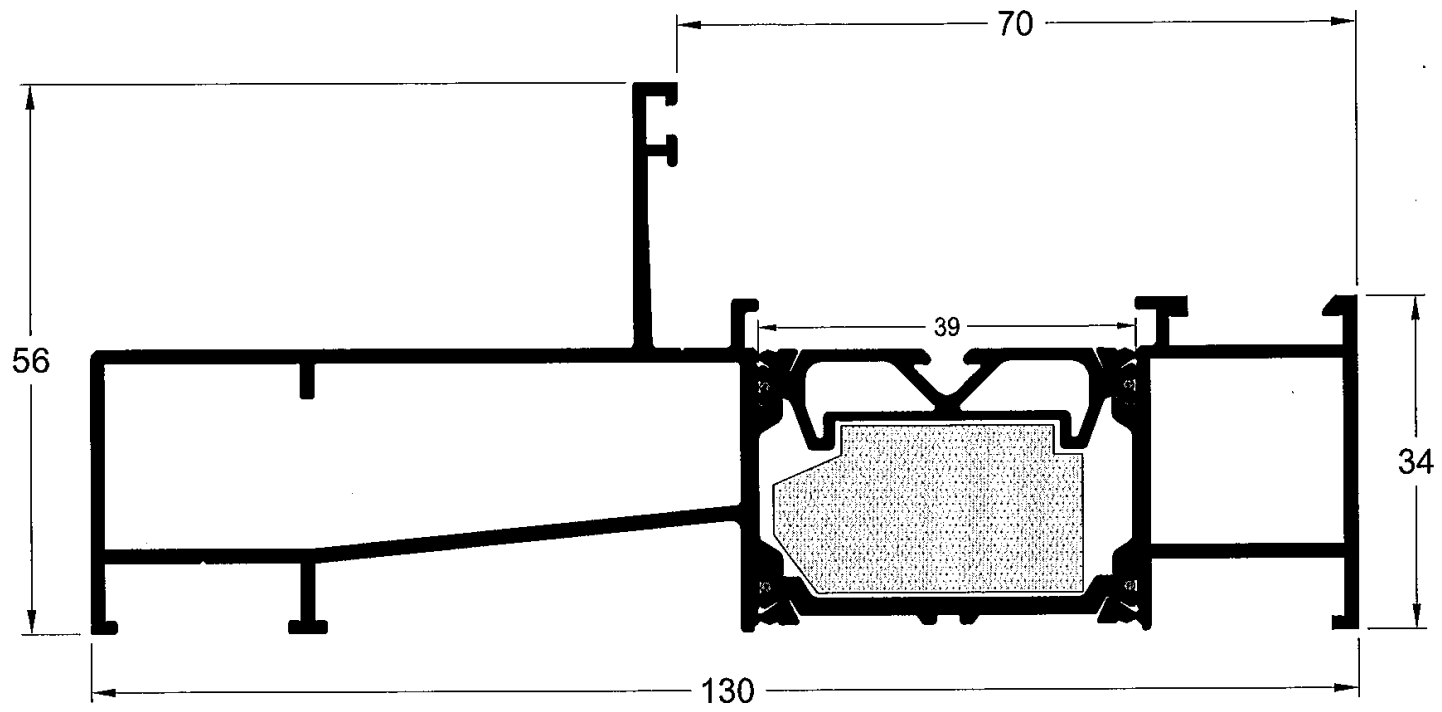

Κωδικός Code	4750-110
Βάρος Weight	1779 gr/m
Περιγραφή	Κάσα
Description	Frame

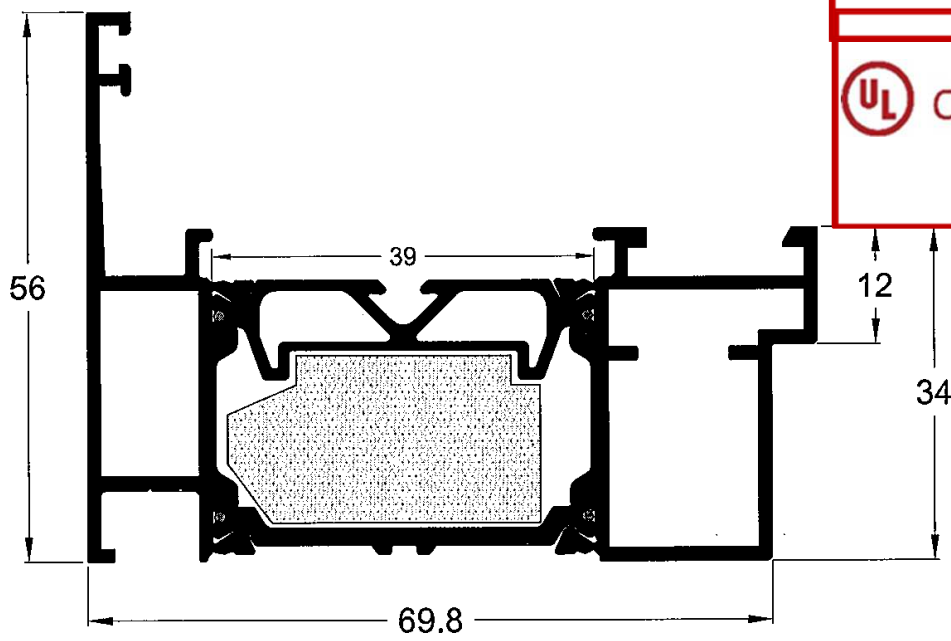

Κωδικός Code	4750-907
Βάρος Weight	1317 gr/m
Περιγραφή	Κάσα αλλαγής φοράς
Description	Frame profile for changing direction

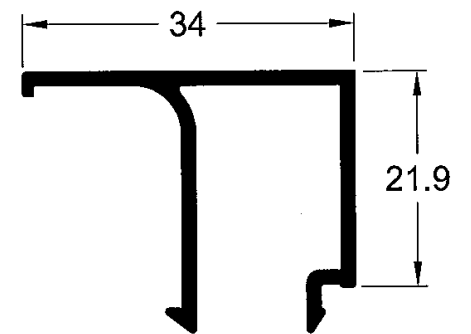
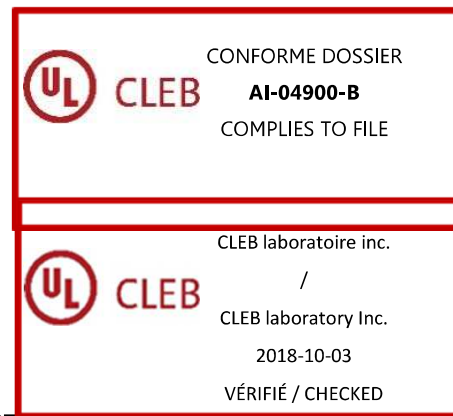

Κωδικός Code	540-777
Βάρος Weight	320 gr/m
Περιγραφή	Πιχάκι
Description	Bead

PRODUCT #2
Testing as per NAFS 2011 Class AW-PG50-Type FW

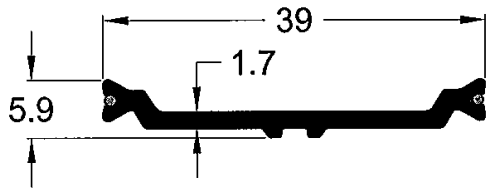

Κωδικός Code	3120-918
Βάρος Weight	87 gr/m
Περιγραφή	Πολυαμίδιο
Description	Polyamide

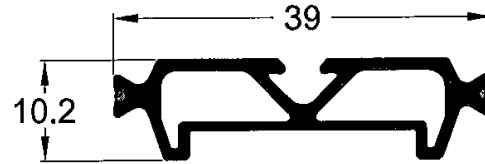

Κωδικός Code	3120-919
Βάρος Weight	153 gr/m
Περιγραφή	Πολυαμίδιο
Description	Polyamide

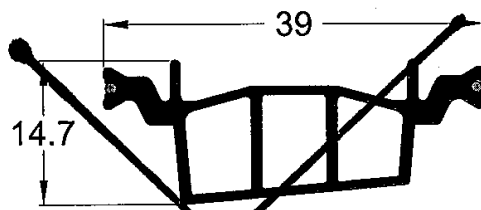

Κωδικός Code	3120-920
Βάρος Weight	167 gr/m
Περιγραφή	Πολυαμίδιο
Description	Polyamide

ETP

	CONFORME DOSSIER AI-04900-B COMPLIES TO FILE
	CLEB laboratoire inc. / CLEB laboratory Inc. 2018-10-03 VÉRIFIÉ / CHECKED